

THIS DRAWING IS UNPUBLISHED. RELEASED FOR PUBLICATION  
 BY AMP INCORPORATED. ALL RIGHTS RESERVED.

LOC		DIST		REVISIONS			
P	LTR	DESCRIPTION		DATE	DWN	APVD	
FT	8	H		REDRAWN W/O CHANGE PER EC 0320-108-96	05 JAN 98	-	-

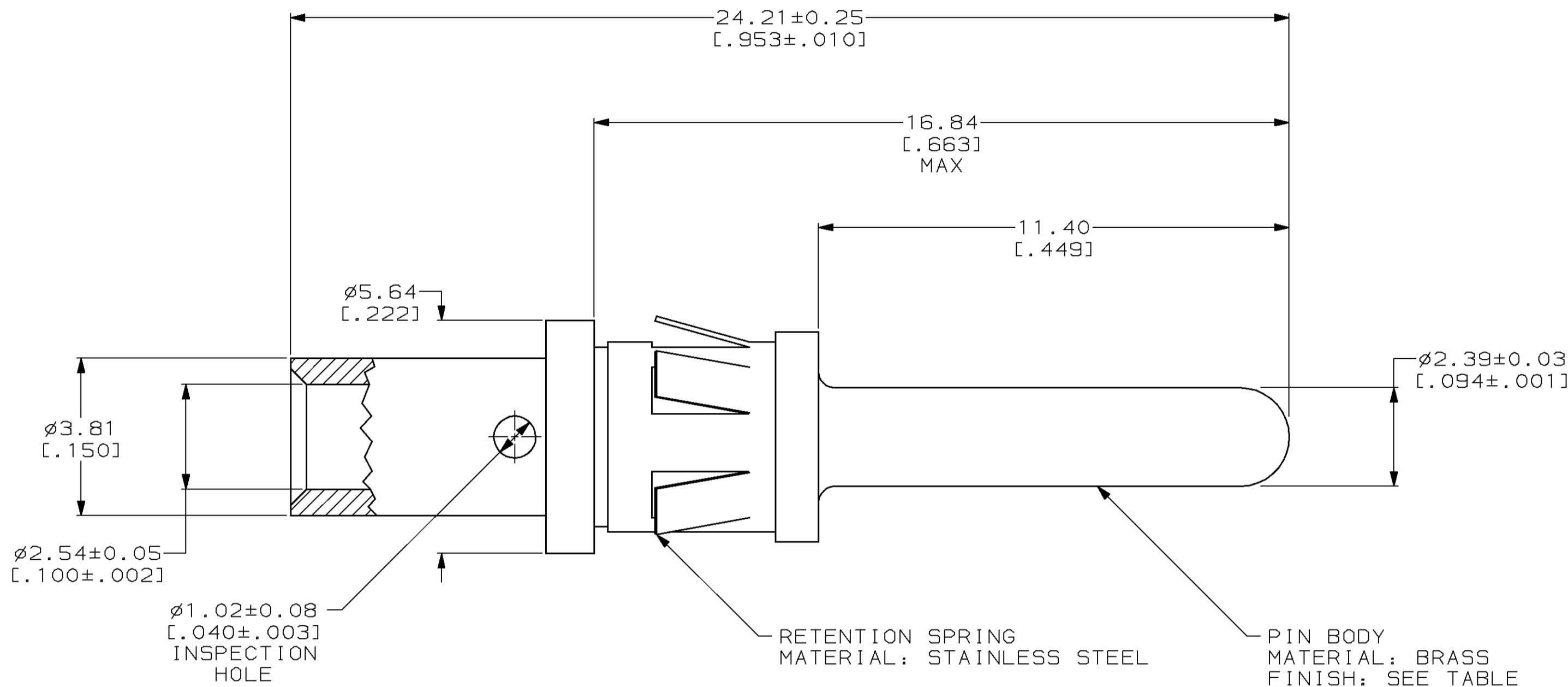

- ①  $0.76 \mu\text{m}$  [  $.000030$  ] MIN GOLD OVER  $1.27 \mu\text{m}$  [  $.000050$  ] MIN NICKEL.
- ②  $3.81 \mu\text{m}$  [  $.000150$  ] MIN TIN.
- 3. ASSEMBLY MATES WITH SOCKET ASSEMBLY 202417.

②	202422-4
①	202422-1
PIN BODY FINISH	PART NUMBER

THIS DRAWING IS A CONTROLLED DOCUMENT.		DWN	B. CARBO	05 JAN 98
DIMENSIONS:		CHK	R. STONE	09 JAN 98
mm [INCHES]		APVD	G. STEINHAUER	30 JAN 98
TOLERANCES UNLESS OTHERWISE SPECIFIED:		PRODUCT SPEC	NAME	
0 PLC	±-	APPLICATION SPEC	-	
1 PLC	±-	WEIGHT	-	
2 PLC	±0.13 [ $.005$ ]	CUSTOMER DRAWING	SCALE	10:1
3 PLC	±-	RESTRICTED TO	SHEET	1 OF 1
4 PLC	±-	REV	H	
ANGLES	±-			
FINISH	SEE CALLOUTS			

**AMP** AMP Incorporated  
Harrisburg, PA 17105-3608

CONTACT ASSEMBLY, PIN,  
#14-#12 WIRE SIZE, TYPE I

SIZE: A2 CAGE CODE: 00779 DRAWING NO: 202422